

LECTRIC
e B I K E S

Lectric XP

Owner's Manual

2020

V 1.2

www.lectricebikes.com

Table of Contents

Contact Information	3
Warning	4
Unboxing	5
Getting Started	5
Folding and Unfolding the Bike	5
Preparing to Ride	7
Recommended Torque Values	8
Battery	9
Operating your battery	9
Keeping Your Battery Healthy	10
Charging Your Battery	10
Battery Safety	11
Operating your new eBike	12
Cockpit Tour	12
Cockpit Instruments	12
Display Control Pad	13
Your First Ride	14
Front and Rear Lights	15
Operating Safety	15
7 Speed Gear System	16
Mechanical Disc Brakes	17
LCD Display Functions	18
Display Readouts	18
Operating the LCD Display	19
Display Settings	20
Changing the Top Speed	21
Battery Capacity Display	22
Kickstand	22
Tips When Riding To Increase Range	22
Maintaining Your Bike	23
Safety	24
Warranty & Disclaimer	25

Thank you for your purchase of a Lectric eBike.

We appreciate your business and we hope you thoroughly enjoy riding your new eBike.

If you need any assistance please do not hesitate to reach out to us.

Contact Information

Email: contact@lectricebikes.com

Website: lectricebikes.com

Phone: (602) 715-0907



Warning

Read this entire manual before assembling or using your new electric bike. Do not modify, disassemble, or replace the original electrical components on your bike. Doing so will invalidate your warranty and could put you in danger. Riding any type of bike comes with some risks which can't be predicted or avoided. Taking proper care of bike components can lower the risk of sudden failure of components but can not prevent it.

These sudden failures could cause serious harm, injury, or death to the rider. If you notice abnormalities in any component on the bike, take it to a licensed mechanic to be repaired or replaced immediately. Lectric eBikes LLC assumes no liability for harm, injury, or death of the rider.

This manual is not intended as a detailed service or repair manual. Seek assistance from your local bike shop mechanic at a reputable bike shop with all the proper certifications and qualifications.

The Lectric XP can withstand most rain showers without sustaining damage. However, the bike and its mechanical and electrical components are not waterproof. We do not recommend storing or using the bike in wet conditions. The warranty for the Lectric XP does not cover water damage.

For technical assistance or warranty claims contact Lectric eBikes at (602) 715-0907 or email at contact@lectricebikes.com.

Unboxing

Getting Started

Congratulations on your purchase of a new Lectric XP eBike! Your bike comes in the box 100% assembled. The instructions that follow are intended to serve as a guide in unboxing and getting familiar with your new bike. The bike may require adjustments upon being received and unboxed, as shipping can sometimes be bumpy. **We recommend seeking professional help from a licensed bicycle mechanic who can help with maintenance and repair.**

What's in the box:

1. Lectric XP eBike
2. Lectric XP eBike charger
3. 2 Battery keys
4. Manufacturer manuals

Before riding your bike, remove all items from the box and make sure everything listed above is present. If anything is missing or damaged contact Lectric eBikes immediately for assistance. For video instructions regarding how to unfold your bike visit our youtube page: Lectric eBikes.

Folding and Unfolding the Bike

The Lectric XP comes to you fully assembled so all you have to do is unfold the bike, ensure everything is properly secured, then you can get riding! The Lectric XP folds in the center of the frame as well as at the handlebars.

Handlebars

1. To unfold the bike, start with the handlebar clasp.
2. Pull the handlebars to their upright position and push the clasp down firmly.
3. Once the safety clasp is locked, move the safety pin sideways so it is inserted into the clasp locking it in place.



Frame

1. To unfold the bike frame, grab the handlebar stem and rear end of the bike while standing near where the battery is exposed. Lift the bike slightly off the ground and swing the bike to its closed position.
2. Push down on the clasp firmly until it locks into position.
3. To unlock the bike frame and return it to the folded position, start by sliding the switch labeled “open” to the right.
4. Pull the latch while still holding the switch to the “open” position. You may now fold the bike.

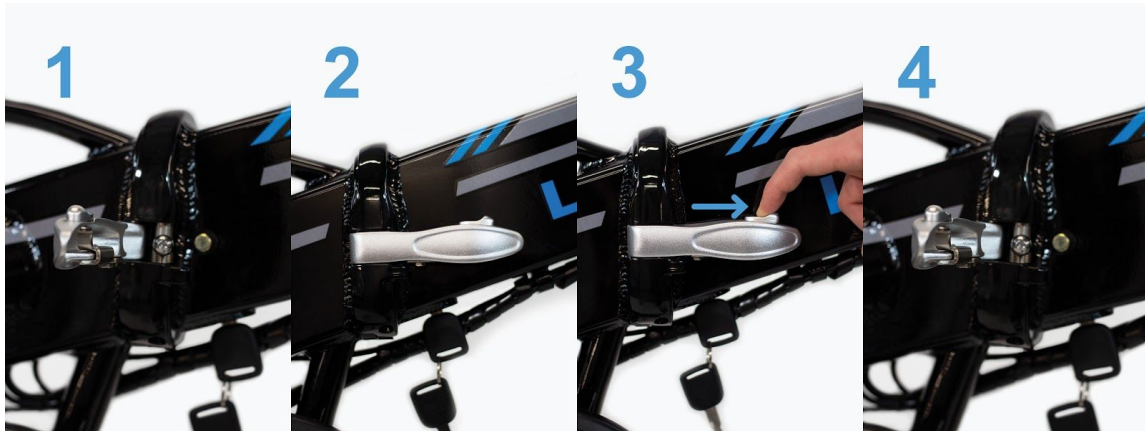

Pedals

1. To unfold the pedals push down slightly and move the pedal outwards.
2. Continue pushing down while lowering it into its unfolded position.
3. Ensure you hear the pedal lock into place once in the unfolded position.



Preparing to Ride

- **Ensure all components are properly secured before riding otherwise serious harm or death could occur. This includes but is not limited to: pedals, handlebars, handlebar clamp, cranks, seat, and seatpost clamp.**
- Make sure you can't twist the seat or stem out of alignment by hand.
- Check to see if your saddle is positioned at the proper height. Sit on the saddle facing forward and place the ball of your foot on the pedal at its lowest point. Your leg should be mostly straight at this point with a slight bend at the knee. You should be able to pedal the bike without overextending your leg when the pedal is at its lowest point. Your legs may be overextended if it causes your hips to move side to side, which means the seat must be lowered.
- To adjust your seat up or down, unlatch the seatpost clamp. Move the seat to the desired height and close the seatpost clamp. The open and closed positions of the seatpost clamp are shown below (open position on left, closed position on right).



- If you need to adjust the angle of your seat, loosen the nuts on both sides of the seat, move the seat to the desired angle, then tighten the nuts. The nut's location is shown below.



- Ensure all cables and connectors at the front of the bike are securely connected or certain components may not work including the front light, the motor inhibitor switches, LCD display, and throttle. The motor inhibitor switches shut the motor off as soon as the rider hits the brakes. **If these switches are not operational it will take longer to slow down which in some riding situations could cause injury or death to the rider.**

Recommended Torque Values

It is recommended that fasteners be tightened to the manufacturer's specification found below:

Part	Required Torque (N*m)
Front Wheel Axle Nuts	40
Rear Wheel Axle Nuts	40
Disc Rotor Mounting Bolts	7
Brake Lever Clamp Bolts	7
Brake Caliper Mounting Bolts	7
Shifter Clamp Bolt	5
Seatpost Clamp	9
SaddleRail Binder	22
Pedals	35
Bottom Bracket	65
Headset Parts	34
Stem Binder Bolt	21
Handlebar Stem Clamp Bolts	10
Handlebar Stem Quick Release	7
Rear Derailleur Cable Clamp Bolt	4
Rear Derailleur Mounting Bolt	8
Crank Bolts	45
Torque Arm Bolt	7
Fender Mounting Bolts	6
Rear Rack Mounting Bolts	7
Kickstand Mounting Bolts	10
Headlight Mounting Screw	7
Spokes	160-180 (KGF)

Battery

Operating your battery

Your bike comes with a 48V 10.4Ah lithium ion battery with LG cells. Key operating features of the battery can be found below:

1. Your bike's battery comes with a set of keys that are used to turn it ON/OFF as well keep it LOCKED/UNLOCKED to the frame. Each battery has a unique set of keys.
2. The battery has 3 positions: UNLOCKED, OFF, and ON. These positions are marked on the battery as shown below.



3. When your battery is in the UNLOCKED position, you will be able to remove it from the frame and the power will not be active.
4. When turning your battery from the UNLOCKED to the OFF position you must PUSH the keys in firmly. In the OFF position the battery will be locked to the frame, but the power will not be active.
5. To turn the power from the OFF to the ON position you must turn the key clockwise. In the ON position the battery will be locked to the frame, and the power will be active. You will not be able to remove the keys from the battery in this position. **The keys must be turned to this position for your bike to work.**

Keeping Your Battery Healthy

- If you know you won't be using the battery for more than a few days keep it charged at about 75% capacity. At 75%, the battery will degrade less than at higher charge levels.
- Periodically check your batteries charge level about once per month and charge back up to 75% if necessary.
- If you want to increase the number of cycles your battery will last for, charge your battery to 100% a few hours before you plan to ride it. For example if you ride the bike and the charge level falls to 50% but you plan to use the bike again in a few days, wait until the night before you plan to use it again to charge it up to 100%. When the battery is not in use this is healthier for the individual cells in the long term.

Charging Your Battery

Locate the charge port on the side of the battery. You can charge the battery from this port while the battery is on or off the bike.

The battery on the Lectric XP comes with almost a full charge. **You should plug your battery in when you first receive it to ensure it is fully charged prior to your first ride.**

- The battery can be charged while attached or detached from the bike.
- You can remove the battery by inserting the key into the lock on the underbelly of the frame. Push the key in firmly and turn counterclockwise (if looking at the bike from below) to unlock. Remove the key from the battery and slide the battery out of the frame until it is free.
- To lock the battery, insert the key into the lock on the underbelly of the frame. Turn the key clockwise (if looking at the bike from below).
- Do not charge the battery with chargers other than the charger provided by Lectric eBikes.
- Only charge the battery indoors in dry spaces which are not excessively hot or cold (Within 10°F of room temperature).
- Ensure there is no dirt or debris nearby when using the charger.
- The charger will automatically stop charging once the battery reaches its full capacity.
- The light on the charger will be red when the battery is charging and will turn green when charging has finished.
- Avoid leaving the charger plugged in when the battery is fully charged.
- Do not charge the battery if you notice the battery is damaged, excessively hot, leaking, smells, or is discolored.
- Charging the battery should take approximately 4-6 hours if the battery is mostly empty.
- Store the battery indoors in a dry space, away from heat or flame sources and out of direct sunlight.

Battery Safety

- Do not submerge the battery in liquid of any kind.
- Do not touch the terminals at the back of the battery.
- Turn off the battery when not in use and before removing from the bike.
- The battery should not be excessively difficult to attach or remove from the battery mount. Do not force the battery to avoid the risk of damage or personal injury.
- Battery charging times may increase with battery age and usage.
- Only grab the charger by the plug and not the cable when plugging and unplugging from the wall.
- If the battery has trouble charging, discontinue charging and contact Lectric eBikes immediately.

Lithium Ion batteries can be dangerous. Take care when using and charging your battery. Failure to follow the above guidelines could result in damage to property and/or serious injury.

Operating your new eBike

Make sure you read this entire manual before turning on and operating your eBike.

Now that your eBike is unfolded it is almost time to start riding. The Lectric XP eBike is equipped with pedal assist, a twist throttle, and can also be used as a regular bike. To use electric assist, the battery must be charged, inserted into the frame, and the key must be in the battery and turned to the ON position.

Cockpit Tour

Before learning about how to operate your new eBike, it is important you know where all of the important controls are located. Below are photos showing where key controls and features are on your eBike.

Cockpit Instruments



Location	Component
1	Display control pad
2	LCD Display
3	Shimano gear shifter
4	Half twist throttle

Display Control Pad



Location	Component
1	Up button
2	Down button
3	Mode button

Your First Ride

To use your electric bike:

1. **Ensure your battery is fully charged before your first ride.**
2. If the battery is not already inside the bike, slide it inside of the frame and lock it in position. Make sure the battery is all the way inside the bike. Once the battery is secured inside, insert the key into the battery via the port on the underbelly of the frame near the seatpost. The location of the key port is shown below.



3. Push the key in firmly and turn the key clockwise to lock the battery to the bike and turn it to the ON position. You will not be able to remove the keys from the battery in this position.

Note:

- **Make sure to push the key in firmly to be able to turn the key to the ON position.**
 - **The key has to be inside the battery and turned to the ON position in order to operate the bike. In this position you will not be able to remove the key from the bike. See the BATTERY section of this manual for further information.**
 - **Before transporting the bike on a bike rack remove the battery from the bike.**
4. Hold down the mode button on the button pad located on the left handlebar until the display comes on.

5. Select a level of pedal assist using the up and down arrows on the button pad. Pedal assist level 1 is the lowest level of assist and pedal assist level 5 is the highest level of assist. Level zero will provide no assistance.
6. The right handlebar features a half twist throttle. To operate the throttle, ensure the pedal assist level is set above 0, then twist the throttle back slowly according to how much speed and acceleration you want to achieve. The farther you twist the throttle from its resting position, the more power propels the bike forward. When the bike is at a complete stop, turn the display off. This will ensure that the motor will not activate until the display is turned back on and the rider is ready to go. **(Note: Exercise extreme caution using the twist throttle. When at a complete stop with the bike turned on, be careful not to twist the throttle unknowingly or the bike could throw you off balance and cause serious harm, injury, or death.)**
7. To turn on the headlight and taillight, press and hold the up arrow on the button pad. The battery must be inside the bike when it is in its unfolded position in order for the headlight to work.
8. **DO NOT HOLD DOWN THE DOWN ARROW ON THE DISPLAY CONTROL PAD WHILE THE BIKE IS POWERED ON. THIS WILL TRIGGER UPHILL WALK MODE WHICH IS ONLY INTENDED FOR USE WHEN DISMOUNTED FROM THE BIKE, WALKING UP EXTREMELY STEEP GRADES. ENGAGING UPHILL WALK MODE ON FLAT GROUND MAY CAUSE INJURY/DAMAGE TO THE BIKE/RIDER.**

Front and Rear Lights

The Lectric XP comes with fully integrated front and rear lights. Please use these lights when riding at night or in low visibility situations. To turn the lights on, hold the up button on the display control pad until the lights turn on. To turn the lights off repeat.

Operating Safety

Before riding the bike for the first time ensure that you have read and understood this manual. Make sure you understand how to turn on and activate the pedal assist and throttle. When first riding the bike take care to start slowly in a low level of pedal assist. Take your first ride in a safe area away from cars, other bikers, pedestrians, or other potentially dangerous obstacles. Only move up pedal assist levels when you feel comfortable and you have ample experience riding the bike. The higher pedal assist levels will accelerate you to higher speeds more quickly. Take care when riding the bike at any speed. **Failure to adhere to warnings and guidelines in this manual can lead to serious harm, injury, or death.** Damage sustained by the bike from failing to follow instructions, guidelines, and warnings in this manual is not covered under warranty.

7 Speed Gear System

The Lectric XP comes with a 7 speed Shimano freewheel (Note: the freewheel is the cluster of sprockets on the rear wheel of the bike). This allows the rider to maintain a comfortable level of effort and pedaling speed throughout different terrains. For instance, while pedaling in lowest gear (the largest sprocket), it will be easier to pedal up hills. In the highest gear (the smallest sprocket), the rider will be able to reach higher speeds on flat or downhill terrain. 1st gear is the lowest gear of this drivetrain while 7th gear is the highest gear. Use the thumb shifter on the right handlebar to shift gears up or down. To shift up press the lower button. To shift down push the lever on the top of the shifter. A photo of the shifter can be seen in the photo below.



Do not change gears too quickly as doing so could cause the chain to fall off and the rider to lose control, which could result in serious injury. If the chain falls off, turn the bike off before fixing the chain. If you do not and the motor turns on you could sustain serious injury.

Mechanical Disc Brakes

The Lectric XP is equipped with mechanical disc brakes to ensure that you can stop quickly even at high speeds. The brakes are engaged by squeezing the brake levers towards the handlebars. This pulls the brake cable which closes the brake caliper. The brake caliper then makes contact with the brake rotor which is attached to the bike wheels. The more you squeeze the brake lever the more force will be applied and thus the faster the bike will slow down. The left brake lever activates the brake on the front wheel and the right brake lever activates the brake on the rear wheel. The right brake lever should always be applied before and while the front brake is also being applied. **If only the front brake is applied while slowing or stopping quickly, the rider may be ejected over the front handlebars. This could result in serious harm, injury, or death. To avoid this always apply even pressure to both brakes when slowing down or stopping.**

Before riding, ensure the brake lever does not touch the handlebars when fully applied. If it does, screw or unscrew the barrel adjuster to increase tension in the brake cable. If this does not fix the problem, take the bike to an experienced bicycle mechanic for further adjustment.

Note: Disc brake rotors will become hot during use and will stay hot for a short period after use. This is due to the high amount of friction between the brake pad and the rotor. Ensure you do not touch the disc rotor right after use.

Contact Lectric eBikes if you have ANY questions regarding the operation of your Lectric eBike.

LCD Display Functions

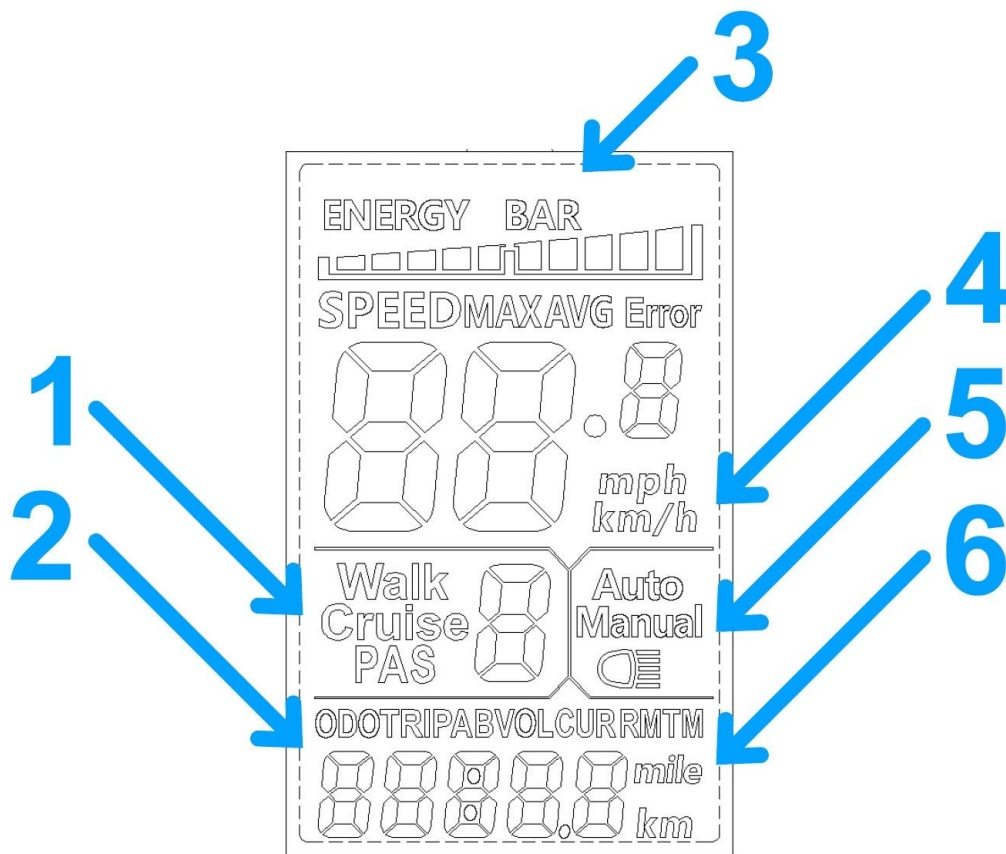

Display Readouts

Location	Description
1	Pedal assist (PAS) Level Indicator
2	Odometer, Trip A, Trip B, Voltage, Current, TM readouts
3	Battery level indicator bar
4	Speedometer in MPH or KM/H
5	Light On/Off Indicator
6	Mile and kilometer indicators

Operating the LCD Display

Function	Instructions
Turning the bike ON/OFF	Hold the mode button until the display turns on
Increase Pedal Assist Level	Press up arrow button
Decrease Pedal Assist Level	Press down arrow button
Turn ON/OFF front/rear lights	Hold the up arrow button for 3 seconds until lights turn on, repeat to turn off
Toggle Odometer, Trip A, Trip B, Voltage, Current, Trip timer (TM)	Press and let go of the mode button

When the bike has not been used for 10 consecutive minutes the display will automatically shut down. The pedal assist and throttle features will no longer work when the display is turned off.

Display Settings

To change display settings hold the up and down arrows simultaneously to enter into the advanced settings menu. In this menu clicking the mode button will toggle between each numbered setting. To adjust the value of each setting click the up and down arrows accordingly.

Setting	Function	Default	Explanation
P01	Brightness	1	Backlight display brightness. The darkest level is 1, the brightest level is 3.
P02	Distance Units	1	Distance Units. 0: KM; 1: MILE.
P04	Sleep	10	LCD Display sleep timer. With the default setting, the display will turn off after it has not been used for 10 minutes.
P08	Speed Limit	32	Speed limit. Range is 0-100. The input data here represents the maximum operating speed of the vehicle: for example, input 25 indicates that the maximum operating speed of the vehicle will not exceed 25km/h; The drive speed is maintained at this set value. The max value allowed is 45. Anything above this will not be recognized. Error: ± 1 km/h
P09	Throttle Toggle	0	0: throttle is active 1: throttle is inactive
P11	PAS Sensitivity	3	Sensitivity of PAS sensor. When set to higher numbers, it will take more crank rotations for the motor to turn on. On lower numbers, it will take little crank rotation to turn on the motor.
P12	PAS Strength	1	Strength of PAS mode. When set to higher numbers, the motor will come on stronger. On lower numbers, it will be more gentle.

Ensure you do not change settings that are not listed in the above table. Changing other settings may cause your bike to stop working properly. If you need the default settings for the advanced settings menu contact Lectric eBikes.

Changing the Top Speed

The Lectric XP ships to all customers being capable of a maximum of 20 miles per hour (mph). This means it is a class 2 electric bike in states that recognize 3 classes of eBikes. In most states that only recognize eBikes generally, the 20 mph top speed is legal for use on public roads. A table detailing each class of electric bike can be seen below.

Class	Pedal Assist Top Speed	Throttle Top Speed
1	20mph	Throttle not allowed
2 (default)	20 mph	20 mph
3	28 mph	20 mph

You must check your local laws and regulations to determine if it is lawful to ride class 3 eBikes on public roads before adjusting the bike's top speed. Laws vary by trail, path, and road so be sure to check in each new location you will be riding.

States that recognize 3 classes of eBikes require a label to be placed on the bike denoting the class the eBike falls into, the motors wattage rating, and the top speed the bike will assist up to. Your bike comes as a class 2 bike by default and has a sticker with this information posted under the carry handle, near the seat post on the bike. If you change your bike's top speed you must remove this sticker from the bike and replace it with a class 3 label detailing the eBike's class, top pedal assisted speed, and motor wattage. The class 3 label is located directly under the class two sticker. To change the top speed of the bike:

1. Access the settings menu by pressing and holding the up and down arrows on the control pad simultaneously until the screen says "P1".
2. From here you can cycle through settings by hitting the "m" button on the control pad and adjust the settings by pressing the up or down arrows on the control pad.
3. Please go to setting "P08" and change this setting from 32 to 45.
4. Press and hold the up and down arrows on the control pad until the main screen is shown once again.
5. Power the bike off by holding the "m" button to save the settings you have just changed.

Congratulations! You can now cruise at speeds of up to 28 mph on your Lectric XP! **Exercise increased caution as riding at higher speeds poses an increased safety risk and may result in serious injury or death. Always wear a helmet and obey the rules of the road.**

Battery Capacity Display

On the top of the LCD display a battery indicator bar can be found which is labeled “energy bar”. This battery indicator shows the estimated charge level left in the bike's battery. As the battery depletes, tick marks will begin to disappear according to approximately how much charge in the battery has been used. The various charge level indicator states are shown below. Note that the battery display will flash when there is no charge remaining.



Kickstand

Do not lean on the bike when it is parked and the kickstand is in use. Doing so will put excess stress on the kickstand and this may cause it to fail, in turn causing harm or injury to the person leaning.

Tips When Riding To Increase Range

Extending Range

To get the maximum range out of your bike there are some simple things you can do:

- Ride in a lower level of pedal assist
- Use lower assist levels and pedal when climbing hills
- Pedal when starting from a standstill
- Set your max speed lower than 20 mph on the LCD display

Rough Range Estimates

The range the bike can go on a single battery charge can vary significantly between riders, terrain, wind conditions, user input, and additional payload weight. The following table is a rough estimation of ranges riders should expect in different conditions.

Rough Range Estimate	Conditions
25 Miles	<ul style="list-style-type: none">• Pure throttle use• Mostly assist level 5• Flat ground• Little to no wind• Rider weight ~180 lbs• No additional payload
35 Miles	<ul style="list-style-type: none">• Little use of throttle• Mostly assist level 3• Flat ground• Little to no wind• Rider weight ~180 lbs• No additional payload
45+ Miles	<ul style="list-style-type: none">• Very little use of throttle• Mostly assist level 1-2• Flat ground• Little to no wind• Rider weight ~180 lbs• No additional payload

Maintaining Your Bike

- Store your bike in a clean dry place to avoid rust.
- Periodically clean and lubricate moving parts and keep components tightened to the torque specifications listed in this manual.
- Clean your bike frame with a wet rag and mild detergent.
- After cleaning ensure lubrication is applied where necessary.
- Ensure your bike tires are always inflated to a pressure within the recommended range printed on the side of the bike tires.
- Before each ride check wires and connections to ensure there is no damage.
- **The Lectric XP is not waterproof.** The electrical components can get wet and likely not sustain damage in most rain showers, however, Lectric eBikes does not recommend riding or storing the bike in wet conditions or severe weather. **Water damage is not covered under warranty.**

Safety

Helmets and Local Laws

Always wear a helmet when riding your eBike. Ensure that the helmet fits your head and is securely tightened down. Before riding, read local laws and comply with all rules relating to biking and eBiking in your area. If you attach a seat for children to the bike they must also be wearing a properly fitted helmet at all times.

Pre-ride Inspection

Before each ride make sure to inspect your eBike to ensure there are no loose fasteners or accessories. Make sure to specifically check that both the front and rear axles are secure. Also make sure both the handlebars and the handlebar stem are not loose. Check the tire pressure of both wheels before riding to ensure the tires are inflated to the recommended pressure printed on the side of the tire walls. Pull the brake levers to make sure your brakes are working properly and adjust if necessary.

Riding in wet conditions

This electric bicycle can withstand light rain and small splashes, but is not designed to be subjected to inclement weather, heavy showers, or submersion in water. **Use caution when riding in wet conditions as it will take longer to use the brakes to slow down, and also when turning as the tires may slip. The electrical components on the bike are not waterproof, and water damage is not covered under warranty.**

Riding at night

Riding at night comes with more risks than riding during the day due to decreased visibility so riders are encouraged to exercise increased caution. Before riding at night make sure that reflectors are installed on your eBike. For increased visibility also ensure the front headlight and rear taillight are turned on and adjusted such that other people on the road can see them clearly. Riders should wear bright colored clothing at night.

Max weight

The bike can safely carry a total weight of 330 lbs.

If the rear rack is attached to the bike the max weight it can hold is 55 lbs.

Therefore if you have a payload that is 40 lbs the maximum rider weight is 290lbs.

Failure to adhere to these weight limits may result in damage to the bike, the rack, or cause serious injury to the rider.

Warranty & Disclaimer

Lectric eBikes should be operated in accordance with the Lectric eBikes owner's manual provided with the bike. Lectric eBikes warrants to the original registered purchaser that Lectric eBikes shall be free from all defects in material and workmanship for a period of 12 months from the date of shipment, when used in accordance with the owner's manual and for the purpose intended. All other obligations and conditions or liabilities, including obligations for consequential damages, are hereby excluded. The warranty is non-transferrable and only applies to the original owner. This warranty gives you specific rights and purchasers may also have other rights, which may vary by location. Damage caused by failing to adhere to instructions and warnings issued by Lectric eBikes is not covered under warranty. Warranty parts will only be shipped within the continental United States.

Parts covered by the warranty: frame, forks, stem, handlebars, headset, seat post, saddle, brakes (excluding brake pads), lights, bottom bracket, crank set, pedals, rims, wheel hub, freewheel, cassette, derailleur, shifter, motor, throttle, controller, wiring harness, LCD display (excluding damage due to water), kickstand, reflectors, and hardware. The battery warranty does not include damage from power surges, use of 3rd party charger, improper maintenance or other such misuse, normal wear, rust, or water damage.

Necessary precautions must be taken to ensure the bike and battery are not exposed to severe weather conditions. Exposure to very wet, hot, or cold conditions may void the warranty.

We will replace any parts deemed to have been damaged during shipping. Shipping damage must be reported to Lectric eBikes within 14 days of shipment arrival. This applies to all products including bikes and accessories.

You will NOT be refunded as compensation for your time or efforts replacing damaged parts.

Replacement parts will not be sent until photographic evidence has been provided to Lectric eBikes. Lectric eBikes may request additional documentation (such as video) to assist with accurately diagnosing the problem and processing the warranty claim.

Items including the chain, tires, wheels, tubes, battery handle, brake pads, cables and housing, grips, and spokes are considered wear items. These items wear down with normal use and are not covered under warranty. You are responsible for replacing and maintaining these wear items.

Any unauthorized alterations or repairs are not covered and may void this warranty.

For warranty services, please contact Lectric eBikes online support by email at contact@lectricebikes.com. Bikes or parts returned without proper documentation may result in delayed service or denied warranty coverage. Warranty return shipping costs along with duties and taxes are the responsibility of the claimant. All unauthorized returns will be refused.

Note that your insurance policies may not provide coverage for accidents involving Lectric eBikes. To determine if coverage is provided, you should contact your insurance company or agent. Damage as a result of an accident is not covered under this warranty, and Lectric eBikes is not responsible for repair or replacement of damaged bikes or parts.

Lectric eBikes reserves the right to change its warranty at any time and without notice.

Bike Performance Disclaimer

The bikes listed range and top speed are estimates (not guarantees) of expected performance. Performance will vary with rider weight, cargo weight, rider /cargo shape (both contribute to drag), terrain, tire pressure, brake adjustment, throttle vs PAS usage, pedal power, battery charge level, ambient temperature and wind conditions. Under certain conditions it is possible to get ranges and top speeds that are different from the listed estimates.

Liability Disclaimer

Riding any kind of bicycle comes with inherent risks and dangers that cannot be predicted or avoided. These dangers could result in a serious accident, injury, or death of the rider. It is the sole responsibility of the rider to become properly educated and prepared to ride safely. Once in possession of the bike, Lectric eBikes strongly encourages and recommends that all customers have a certified and reputable bicycle mechanic complete a full inspection of each component on the bicycle to ensure it is safe for operation. Lectric eBikes makes no claims or guarantees that the brakes, battery, frame, motor, motor controller, LCD display, electrical cables, electrical cable housings, fasteners, grips, fork, stem, shifters, headset, seat post, seat post clamp, handlebar stem clamp, saddle, wheel hubs, handlebars, spokes, rims, tires, tubes, derailleur, freewheel, cassette, throttle, kickstand, lights, reflectors, hardware, bottom bracket, or any other part or accessory, will be properly secured and adjusted upon arrival. Before every ride fully inspect your bicycle to ensure everything is secured and adjusted properly.

Under no circumstances is Lectric eBikes responsible for any damage resulting from damaged, defective, or improperly secured parts. This includes, but is not limited to, damage to personal property, personal injury, or death.