

ST2 WORK INSTRUCTIONS

ST2 SERVICE MENU

Settings and functions that are not required in normal operation are hidden in a Service menu.

1 CALLING UP THE SERVICE MENU

1. Press the power button to access the shortcut screen.

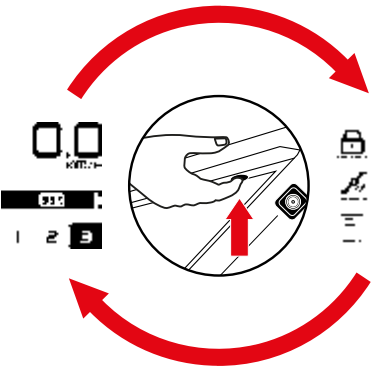

2. Apply the right-hand brake and hold it applied.



3. Select **MENU** and hold it pressed.  
4. Release the right-hand brake

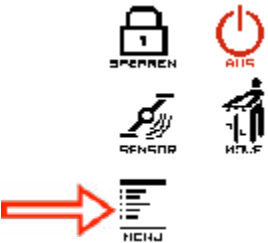

Keep **MENU** pressed until the menu opens



5. The Service menu can be found under the **SERVICE** heading.



ST2 WORK INSTRUCTIONS

ST2 SERVICE MENU

1.1 SERVICE SETTINGS

6. **SIT ENABLE**

See: ST2 - Work Instruction - System Integration Test

**DAYLIGHT**

See: ST2 - Work Instruction - Daytime running lights settings



1.2 ERROR LIST

7. **Error list**

If the last error messages have not yet been sent to the Stromer Portal, they are displayed in the error list.



1.3 SENSOR

8. **TORQ.SENS.**

The TMM sensor is reset at the black button: TMM RESET

See: ST2 Diagnosis Flow Chart - ST2 not assisting



**BRAKEMODE**

Test whether the brake sensors are recognized and are functioning correctly.  
REL = brake is released  
PUL! = brake is applied