

Guangzhou Sameway Electric Bicycle Co.,ltd

LCD-M6T USER MANUAL

2020 Latest Version-V1.0



一、 Size and materia (unit: mm)

The display shell is made of ABS and metal material,the LED screen is made of toughened glass.

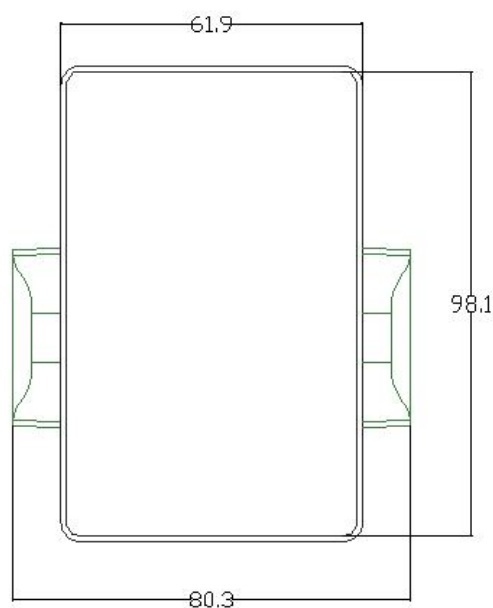

Elevation view

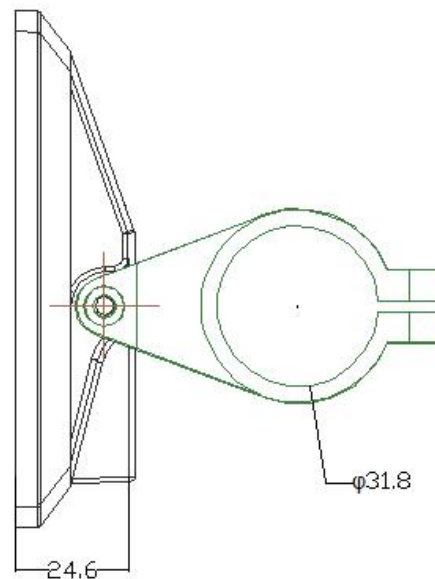

Side view

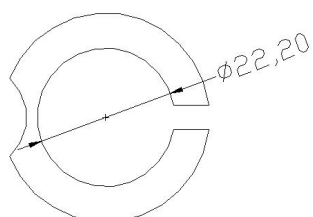

31.8mmThe clamp has 22.2mm、25.4mm、28.6mmto be

chosed

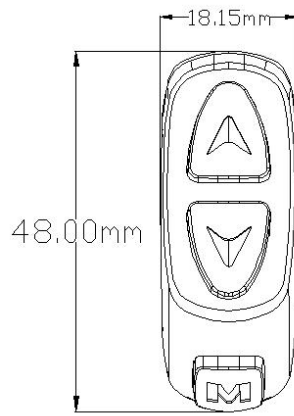

Button view

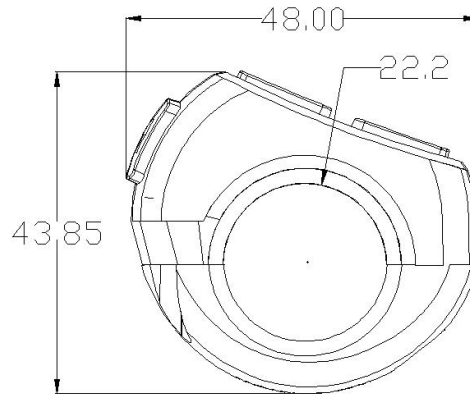

Button side view

二、 Working voltage and method of connecting the line

1、 Working Voltage: DC24V、 36V、 48V、 60V、 64V（ Can be set by display） , Other voltage can be customized

2、 Method of connecting the line:

Standard connector sequence

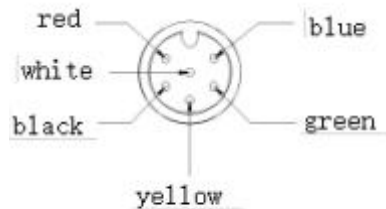

Common view-six

Display outgoing terminal

Sheet: Standard plug-in line sequence table

Standard plug-in line sequence	color	function
1	red（VCC）	Display power line
2	green（RX）	Display data receiving line
3	black（GND）	Display ground line
4	orange（K）	Controller Controlling line
5	yellow（TX）	Display data sending line
6	white（DD）	Light controlling line

Attention:The leads are water-proof connectors so that the user can not see the color of the leads in the harness

三、 Function

1、 Display function

Speed display,PAS display,power display,power indication, fault indication,

total mileage, single mileage, headlamp display, single travel time display

2. Control and setting fuction

Power turn on/off controll,front light control,6Km/h control,wheel size setting,max speed setting, automatic sleep time setting, backlight

brightness setting, voltage level setting

Contents introduction for home page

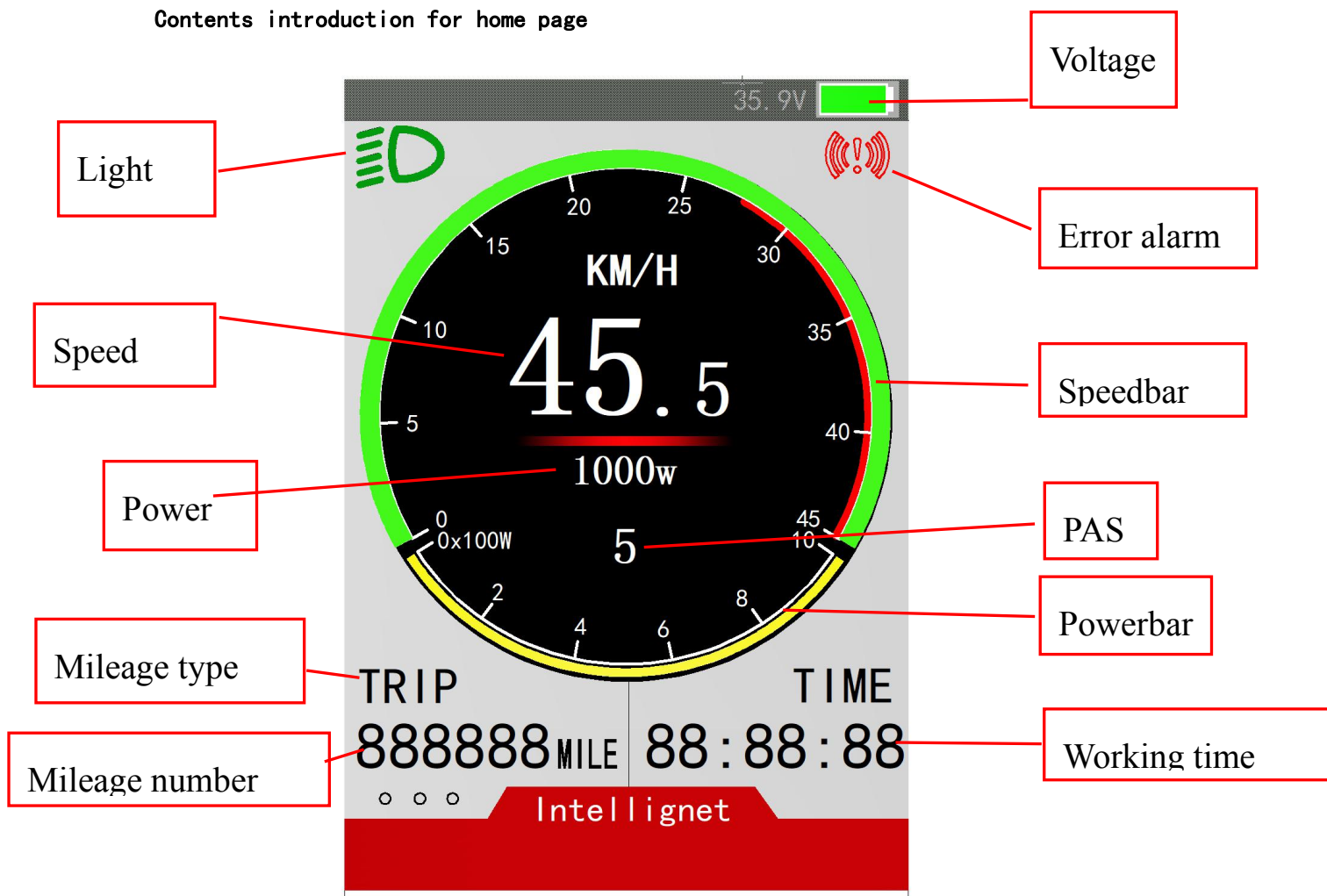

Error alarm :

- under voltage
- brake hint
- motor problem
- Accelerator problem
- controller problem
- communication problem

Status hint Icons:

- USB charging hint
- cruise engaging

Setting page introduction

Normal Options

Brightness	2	(From1-3)
Metric system	KM	
(KIMIHIIDE system switching)		
Voltage	36V	(24V-60V)
Sleep time	10min	(0-60Min)
Wheel size	23in	(5-50inch)
Speed limit	25km/h	(0-100km/h)
ZERO mode	ON	(Need or not)

>Advanced Setup
>Factory Option
Default Settings
Back
Exit and exit

Setting Options

Brightness	2
Metric system	KM
Voltage	36V
Sleep time	10min
Wheel size	23inch
Speed limit	25km/h
Zero mode	ON

>Advanced Setup
>Factory Options
Default Settings
Back
Exit&Save

Advanced Setup

Assist Mode	5	(3、5、9)
Motor Magnets	1	(1-255)
Start Mode	zero	(zero/non zero)
Drive Mode	PAS+Th	(PAS、Th、PAS+Th)
PAS Sensitive	3	(1-24)
PAS Strength	3	(1-5)
ODO Reset		reak-time mileage
(Long press Up button to celar)		
Auto Cruise	OFF	(On/off)

>Back

Advanced Setup

Assist Mode	5
Motor Magnets	1
Start Mode	zero
Drive Mode	PAS+Thro
PAS Sensitive	3
PAS Strength	3
ODO Reset	“实时的总里程数”
Auto Cruise	OFF

>Back“返回上一层”

Factory Options

PAS Magnets	12	(from 5-12)
Current Limit	15A	(1-22)
Under Voltage	29V	(battery under voltage)
Display Speed Rate	100%	(50-150)
Protocol	No. 2	

>Back

Factory Options

PAS Magnets	12
Current Limit	15A
Under Voltage	29V
Display Speed Ratio	100%
Protocol	No.2

>Back“返回上一层”

三、 Button introduction

Pls refer to below button position



Function of the button

There are 3 types of clicking buttons, long click, short click, and two buttons long click together.

Short click is for quick/frequent use, e.g:



1. When riding, if you want to change the PAS speed, you can short press these button.



2. When cycling, switch the multi-function area display data, short click

Long click for one button is mainly for mode changing/turn on/off

Two buttons long click is for setting parameter, because it is difficult to do, this can reduce misuse,

Detail explanation for using buttons :

一、Modify power ratio/electrical gear mode

For example: if now it is assist mode:



- 1) Short click, assist power + 1



- 2) Short click, assist power - 1

二、Switching speed display,



Long click, switch the speed display method

三、Set/cancel 6KM/H mode, turn on/off the light, clear ODO



When not cycling, long click, will enter into 6KM/h mode, when not clicking, it exits the 6KM/H mode.



Long click, the light will be switched on/off



When you are at P16 Menu interface, long click for 6 seconds, ODO will be cleared.



四、Turn on/off display





When the display is working, long click  , the display will be switched off, on opposite, the display will be switched on.

五、Switch multi function display



Short click  can switch multi-function display data

六、Setting parameter

Long press  +  enter into parameter setting menu, below parameter can be set: wheel size(inch), magnet number, screen lightness, under voltage ect (refer to setting: P01-P20) ;

When you are at setting home page, short click  or  , increase or decrease the setting number to the  or  to quickly change the parameter.

1. Short click  switch to next parameter.

2. Long click again  +  , exit the setting and store the parameter, if not do like this, will store the changed parameter and exit automatically in 8 seconds,