

## 6.6 Remote Control configuration

The example on the right shows how the values can be set.

- **Feedback tone enabled:** A sound will be heard when pressing one of the remote-control buttons.
- **Set action to zoom on map page:** The up down buttons of the remote control will zoom the map on the Bike Monitors Map page.

Within the BLEvo remote control configuration page you can set the functions of the upper, middle and lower buttons (▲, ● and ▼). In total you can set 6 commands by short and long pressing each of the three buttons.

The following actions are available to choose:

- **No action**
- **Scroll page:** will switch view between Bike Monitor and Map Screen.
- **+ Power:** increases the assistance by the amount specified by the Power +/- step fields.
- **++ Power:** increases the assistance by the amount specified by the Power ++/-- step fields.
- **-Power:** decreases the assistance by the amount specified by the Power +/- step fields.
- **--Power:** decreases the assistance by the amount specified by the Power +/- step fields.
- **Add waypoint:** add a waypoint during the route. It is then possible to configure the system to verbally dictate the waypoint description.
- **Play audio messages:** play the audio messages set without having to wait for the time event or the set km.
- **Recover the speed limit to 25 km/h:** if the speed limit has been changed, the limit can be reset to 25 km/h. It is necessary to switch off and switch on the bike.
- **Enable/Disable Smart Power**
- **Map Zoom in**
- **Map Zoom out**
- **Toggle map direction:** change map orientation from map to north to map in driving direction.
- **Toggle Stealth mode (2019):** enable / disable the Stealth mode on the Gen2 Turbo Levo.
- **Increase acceleration (2019):** increase the acceleration value on the Gen2 Turbo Levo.
- **Decrease acceleration (2019):** decreases the acceleration value on the Gen2 Turbo Levo.
- **Increase Shuttle (2019):** increase the value of the on the Gen2 Turbo Levo.
- **Decrement Shuttle (2019):** it decreases the value of the Shuttle on the Gen2 Turbo Levo.
- **Ring the bicycle bell:** ring the bicycle bell sound.
- **Audio General Lee:** play the General Lee sound.
- **Decrease Smart HR (-5 bpm):** decrease the Smart HR by 5 bpm.

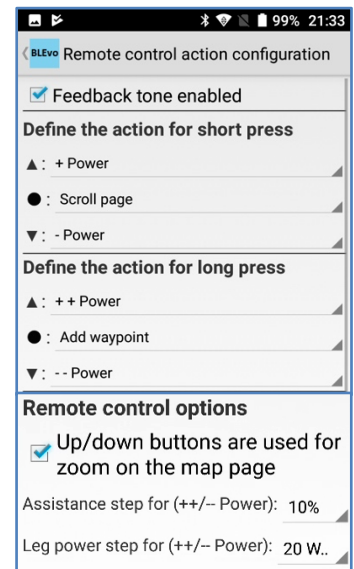

- **Increase Smart HR (+5 bpm)**: increase the Smart HR by 5 bpm.
- **Boost (big assistance step)**: increases assistance by a very high percentage, selectable later

In addition to these actions there is one special action which allows the centre button to cycle through predefined actions.

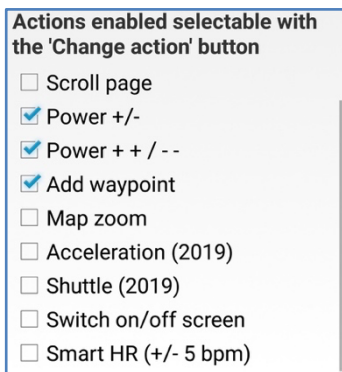

- **Change action**: the action of the ▲ and ▼ buttons is changed every time you select the middle button.

## 6.7 STRAVA Configuration

Allows you to link the BLEvo app to your Strava account. Click the “Add Authorization” button to authenticate.

If you experience future problems with rides not uploading it is recommended that you first remove your authorisation and re-enable before posting for help.

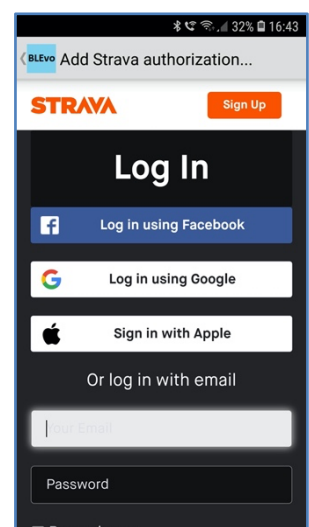

## 7 Smart Power ⚡ and ❤️ Smart HR (Heart Rate)

Smart Power and Smart Heart Rate allows the BLEvo app to control the power output of the bike to ensure you stay within a biker power/heart rate range. The heart rate is measured by your phone or a connected device, whereas the biker power is measured directly by the bike motor.

In order to use Smart HR, you will need a Bluetooth or ANT+ heart rate sensor connected to BLEvo. A list of sensors known to work can be found here [Heart Rate Monitors](#)

The Smart HR ❤️ and Smart Power ⚡ can be configured from the configuration menu.