

Jantos charging cap replacement for Superdelite

Like so many others have experienced, sadly I also lost the plastic cap covering the charging connector of my Riese & Müller Superdelite speed pedelec. As I live in Europe, it was easy to order a replacement item online at <https://www.bikeparts-jantos.de/>.

After about five days, a small package arrived containing the replacement cap along with some instructions on how to swap out old for new cap.

First of all, the replacement cap does not have the same refined polish as the original cap, but on the positive side it looks much sturdier, comes with a small hinge and also small magnets which keep the cap closed.

The replacement cap seems to printed object. From a distance you will not notice that it is not smooth looking. It is just fine.

The replacement cap is not too expensive at € but the shipping cost almost doubles the price! Not sure why shipping is so expensive. Perhaps the manufacturer could consider cheaper shipping options as we really do not need track & trace for such a cheap item.

Ihre Bestellung Nr. 11839 vom 11.10.2021

Rechnung 202110301

Das Rechnungsdatum entspricht dem Leistungsdatum

Pos	Bezeichnung	Menge	Einzelpreis	Betrag
1	Magnetische Ladebuchsenklappe für Bosch Gen4 Motoren	1	14,95	14,95 €
2	Versandkosten	1	13,99	13,99 €
Nettobetrag				23,92 €
Umsatzsteuer 21%				5,02 €
Rechnungsbetrag				28,94 €

All in all I will say the item is worth the total cost as it is actually an upgrade compared to the original cap. I think this one will last much longer.

Inside the box there are instructions on how to replace the cap. You will need to Tork (T10) screwdriver only to complete the replacement without risking the charging connector falling back into the frame. I also plugged in the charger so I could be sure everything was aligned perfectly before tightening the screws.

This job can be completed in less than ten minutes.

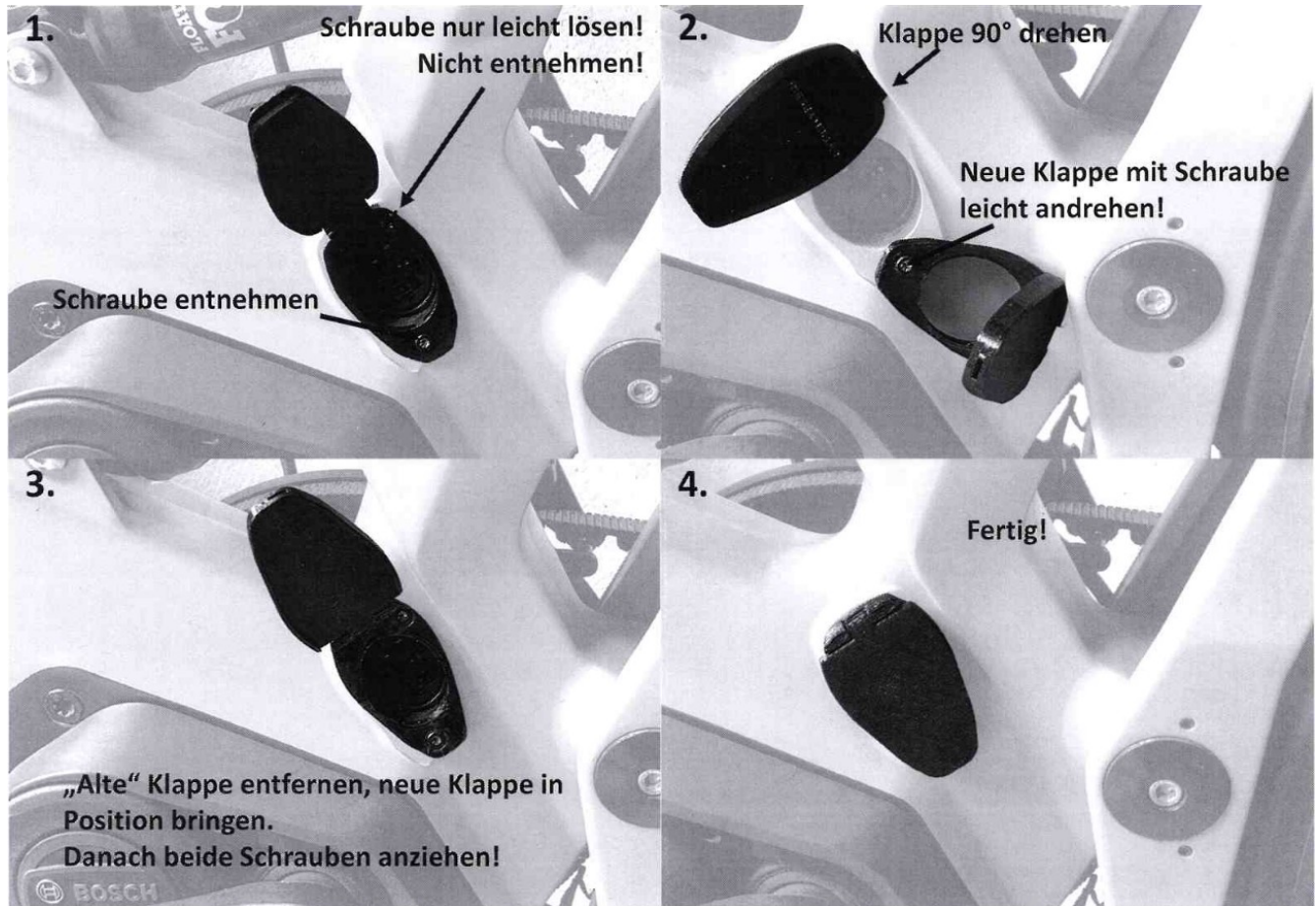

Loosely translated:

1. Top arrow: partly loosen this screw, do not take out completely. Arrow pointing at the bottom of the cap: unscrew completely and take screw out;
2. Turn original cap 90 degrees. Mount new cap with just one screw, do not fasten completely;
3. Remove original cap, and move replacement cap into position. Fasten both screws completely;
4. Ready!

I thought it would be good to share some pictures so you hopefully gain a better understanding of the process, and see the cap itself in more detail:

Step 1 and 2:



Step 2:



A picture showing the length of the screws holding the charging connector and the cap to the frame so you can be confident in unscrewing for 5 millimeters or so to do the replacement.



End result, cap opened:



End result, cap closed:



All in all I am very satisfied with the replacement item, and it was super easy to replace old for new.